

Intake - Hisun, 400-500cc, ATV/UTV - 20A9353 - PBC2830F1

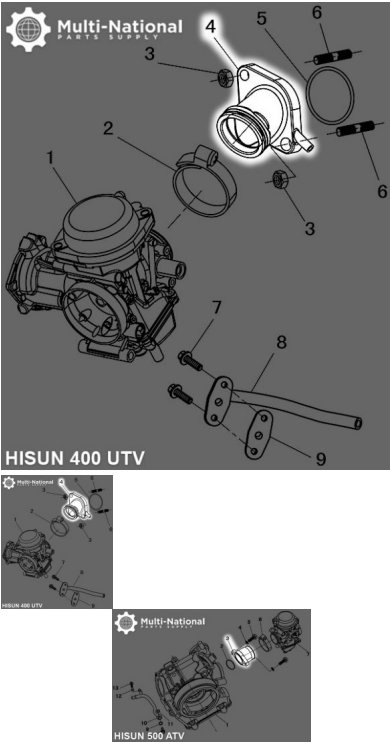

Rating: Not Rated Yet

Price

\$71.42

[Ask a question about this product](#)

Description

Inlet pipe joint. Commonly used for (but not limited to) 400cc and 500cc engines, such as the Hisun 500cc 4x4 ATVs and Hisun 400cc UTVs, as well as many other clones, rebrands and similar displacement machines.

These machines are commonly manufactured by Chongqing Huansong Industries (Group) Co., Ltd. and distributed by a range of exporters, importers and distributors under such brands as: Hisun, Bennche, Coleman, Massimo, Qlink, Menards Yardsport, Big Muddy, Powermax, Nordik, TSC, Rural King, Cub Cadet, Excalibur, US Titan / Supermach, Precision, JMC and many others.

Common Hisun model names are primarily listed as variations of "Hisun 500cc ATV", "Hisun HS500ATV", "HSUN HS500 E-mark EFI", "Hisun 400cc UTV" and "Hisun HS400UTV. Common listed Hisun intake part number is 14800-003-0000 and ERP part number is 14800-003-0000. Also applies to some other variations of Hisun models.

Common Nordik model names are primarily listed "Storm 500 EFI ATV" and "Tornado 400cc UTV". Common listed Nordik intake part number is 14800-003-0000 and ERP part number is 14800-003-0000. Also applies to some other variations of Nordik models.

Common Powermax model names are primarily listed as "Powermax Bearclaw 500 ATV" and "Powermax Renegade 400 UTV". Common listed Powermax intake part number is 14800-003-0000 and ERP part number is 14800-003-0000. Also applies to some other variations of Powermax models.

- 14800-003-0000